



836 SELKIRK SHEATH ADJUSTMENT INSTRUCTIONS

SHEATH FEATURES

- Belt Loop is configurable for vertical or horizontal carry.
- Belt Loop contains a Belt Loop spacer to accommodate different width belts, up to 2" wide.
- Knife retention can be adjusted by tightening or loosening the sheath screw near the blade opening.
- Flathead screwdriver is needed to change configuration (not included).

CONFIGURING SHEATH FOR VERTICAL CARRY

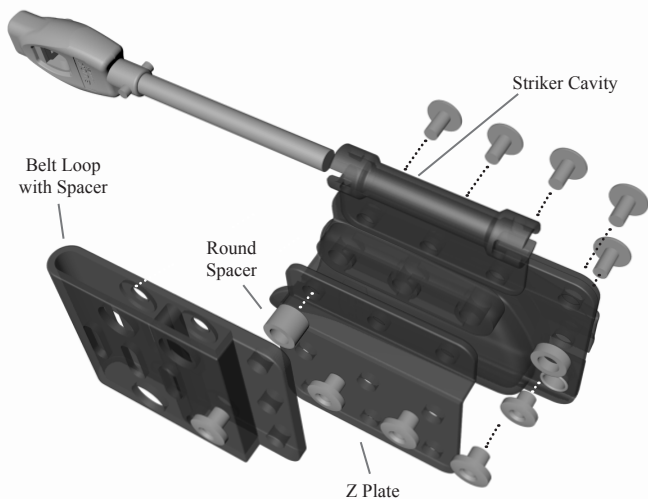

1. Remove screws and parts from the sheath with a flathead screwdriver.
2. Once all of the parts are removed, adjust Belt Loop Spacer to the desired belt size.
3. Attach Belt Loop to the Z Plate with two nuts and bolts.
4. Place optional Striker Cavity on sheath prior to positioning the Z Plate down.
5. Take the assembled Z Plate and Belt Loop and lay on top of the Striker Cavity, positioning the 3 Striker Cavity holes to the 3 Z Plate holes. Insert round spacer and use longer bolt to connect the Belt Loop to the Striker Cavity.
6. Assemble using nuts and bolts.
7. To adjust how tightly the knife fits in the sheath, locate the finger adjustment feature on the front of the sheath. This finger can be tightened down with the fastener to adjust how tightly your knife fits in the sheath.

CONFIGURING SHEATH FOR HORIZONTAL CARRY

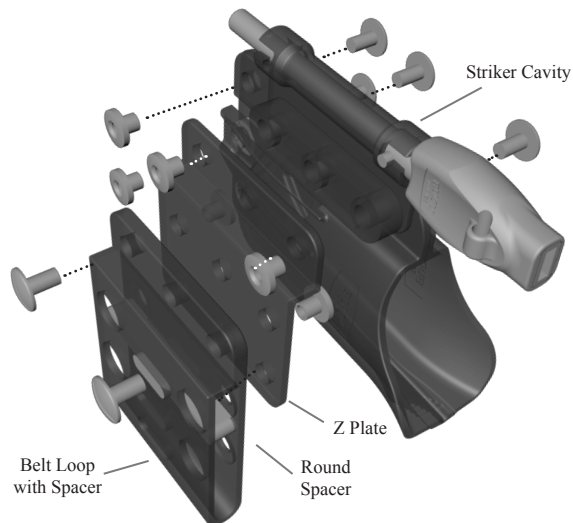

1. Remove screws and parts from the sheath with a flathead screwdriver.
2. Once all of the parts are removed, adjust Belt Loop spacer to the desired belt size.
3. Place Belt Loop on top of Z Plate. Open the Belt Loop and insert two bolts into alternating corners and attach with a nut to the Z Plate.
4. Place optional Striker Cavity on sheath prior to laying the Z Plate down.
5. Take the assembled Z Plate / Belt Loop and lay on top of the Striker Cavity, positioning the 3 Striker Cavity holes to the 3 Z Plate holes. Insert round spacer and use longer bolt to connect the Belt Loop to the Striker Cavity.
6. Assemble using nuts and bolts.

ADDITIONAL FEATURES



- Whistle: to remove whistle feature, rotate whistle 1/4" turn and pull.
- Ferrocerium Striker is part of the whistle feature. To spark, hold knife in position and pull striker along blade notch located near the blade guard.
- Handle pommel can be used as a hammer for light duty tasks.